

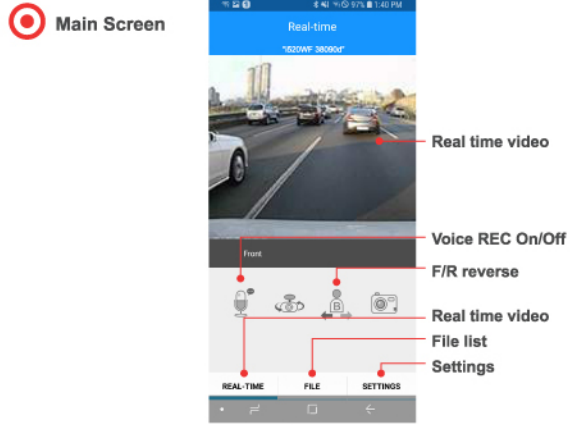

i520WF WiFi APP Guide (Android & iOS)

2 Main Functions



- Real time video**
 - To check real time video.
 - To on/off voice recording.
 - To reverse front/rear video.
- Video file list**
 - To check recorded video files.
 - To download video files to your smartphone.
 - To play the downloaded video files.
- Settings**
 - To configure various settings or change WiFi password.

3 APP Installing (Android)

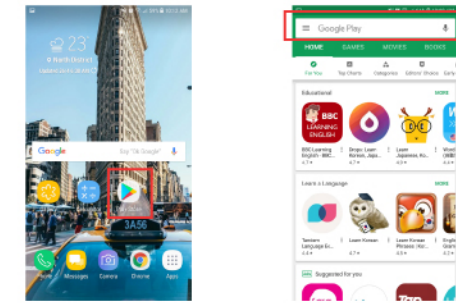

- Go to "Play Store" in the smartphone.
- Go to search in Play Store.
- Type and search "BRAUN i510 / i520WF".
- Choose "BRAUN i510WF / i520WF".

4 APP Installing (Android)

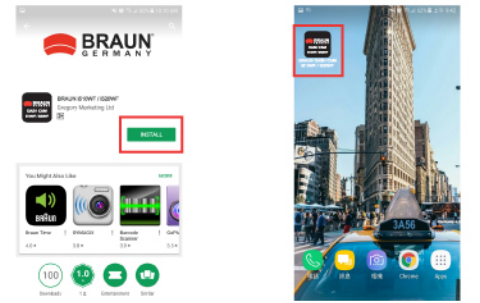

- Install the DVR APP by clicking "Install" button.
- If install is successful, you can see "BRAUN i510WF / i520WF" icon in main screen.

5 APP Installing (iOS)

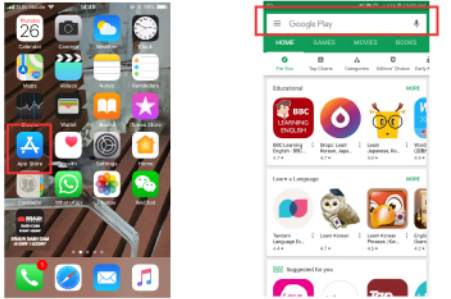

- Go to "APP Store" in the smartphone.
- Go to search in APP Store.
- Type and search "Braun i510WF / i520WF".
- Click "BRAUN i510WF / i520WF" download.

6 APP Installing (iOS)

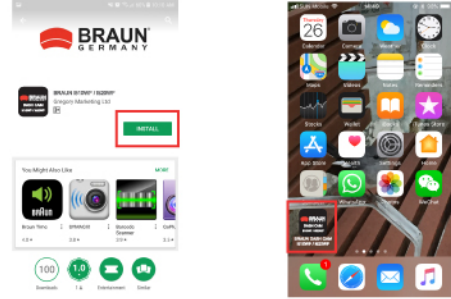

- Download and install the BRAUN i510WF / i520WF APP.
- If install is successful, you can see "BRAUN i510WF / i520WF" icon in main screen.

7 WiFi Connection with DVR (Android)



- Click "BRAUN i510WF / i520WF" icon in the main screen.
- Click "OK" when WiFi Connection screen pops up.
- Choose "BRAUN i520WF_XXXXXX" in the searched list.
- Input password and click connection button. (initial password is 12345678)

8 WiFi Connection with DVR (Android)

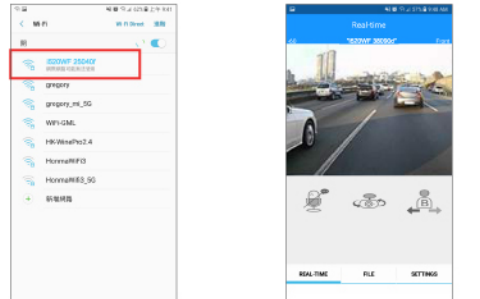

- If WiFi is connected click the backward button of smartphone.
- Real time video screen will be displayed.

9 WiFi Connection with DVR (iOS)

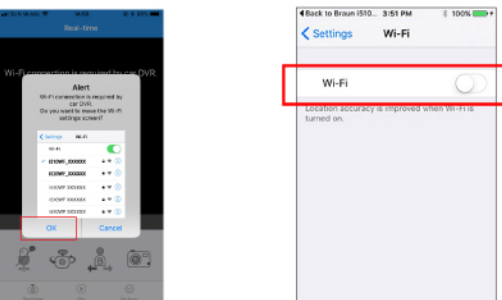

- If WiFi setting screen is displayed click "OK".
- If WiFi is off, turn on the WiFi.
- Choose "i520WF_XXXXXX" in the searched list.
- Input password and click connection button.

10 WiFi Connection with DVR (iOS)

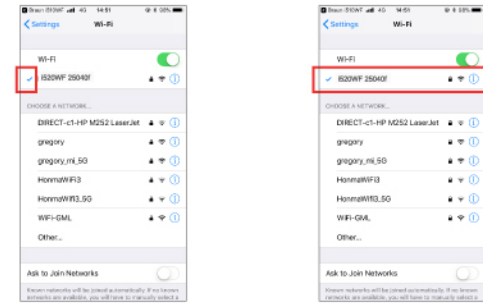

- If WiFi is connected, you can see "✓" mark.
- Click "return to BRAUN i520WF" on the top line.



- Real time video screen will be displayed.

11 Recorded File List

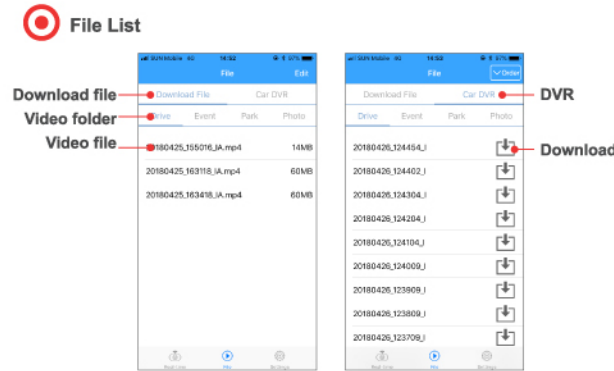

- File List**
 - It displays downloaded file list to smartphone.
 - Folders have driving/event/parking/photo folders.
 - Click the file in each folder to play.
 - File storing folder : internal memory / BRAUN i520WF.
- Recorded File List (Downloaded file)**
 - It displays downloaded file list to smartphone.
 - Folders have driving/event/parking/photo folders.
 - Click the file in each folder to play.
 - File storing folder : internal memory / BRAUN i520WF.
- Recorded File List (DVR)**
 - It displays files stored in DVR.
 - Folders have driving / event / parking / photo folders.
 - Click the file in each folder to play.
 - If you click download icon next to the file, the file will be downloaded in your smartphone.
 - Front and rear video files are downloaded separately.

12 Video Playback

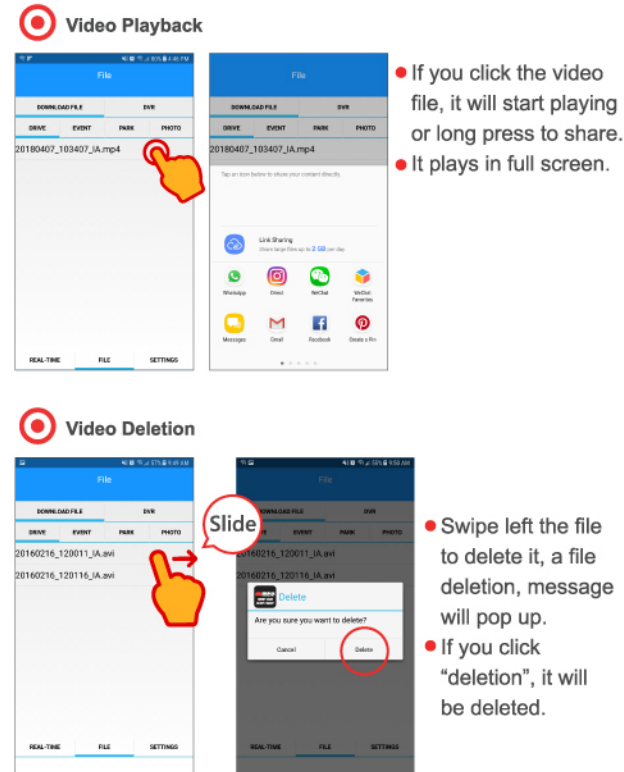

- Video Playback**
 - If you click the video file, it will start playing or long press to share.
 - It plays in full screen.
- Video Deletion**
 - Swipe left the file to delete it, a file deletion, message will pop up.
 - If you click "deletion", it will be deleted.

13 Settings

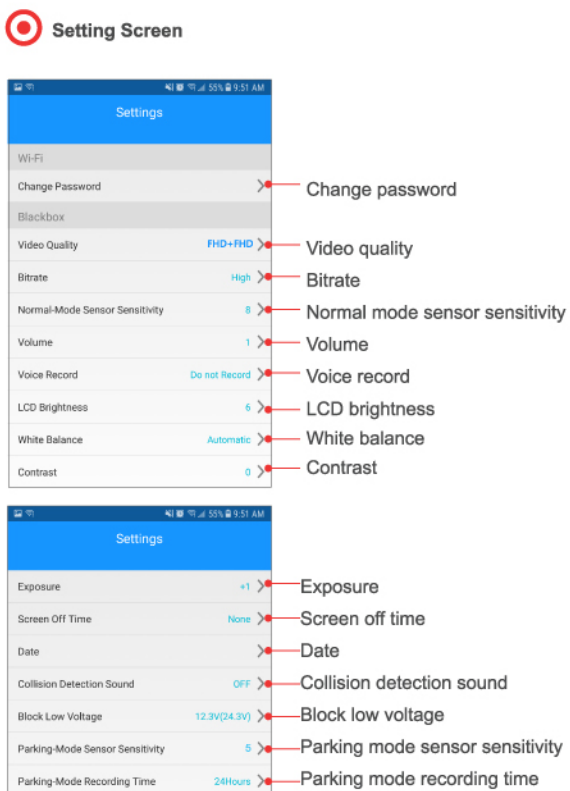

14 Settings

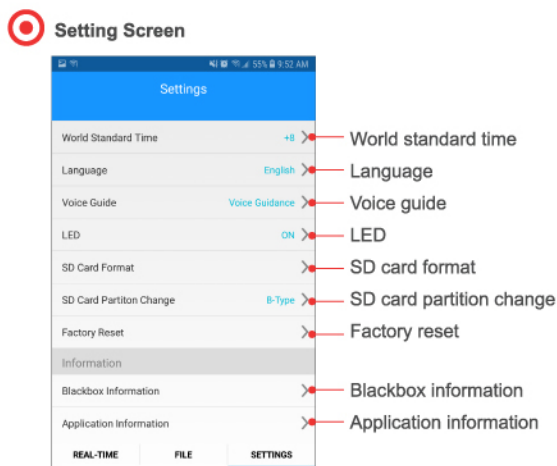

- Change password**
 - Password is for preventing somebody to see the video.
 - You need to input password to play the video files.
- Video resolution**
 - You can select Full HD+Full HD or HD+HD.
- Normal mode sensor sensitivity**
 - Setting impact sensor sensitivity in driving mode.
 - Smaller number means higher sensitivity.

15 Settings

- Voice record**
 - Recording voice together with video.
 - Voice recording can be set in the display of the main camera.
- Date**
 - If your DVR have the external GPS connected, time is set automatically.
 - If there is not GPS you need to set date and time manually.
- Block low voltage**
 - If car battery power voltage drops to a certain level, in order to prevent battery discharge, DVR power is off automatically.
- Parking mode recording time**
 - In parking mode, if it keeps recording, car battery could be discharged.
 - In order to prevent battery discharge, you can set parking recording time.
- World standard time.**
 - Set up your local time. For example, UK time is "0".
 - Korea time is "+9".
- SD card partition change**
 - SD card stores each type recording files in each different memory space.
 - You can choose A/B/C memory size type.